

## SHUNTS

### SEPARATE SHUNTS

Separate shunts increase DC current ratings when connected with the meter with a moving coil. Voltage drop is 60 mV. Connection wires with 0.035  $\Omega$  resistance are enclosed to the shunt. Dimensions comply with DIN 43703. The accuracy class is 0.5.



AR 0101

RATED CURRENT (A)/60 mV	MASS (kg)
1, 1.5	0.18
2.5, 4, 6, 10, 15, 25	0.20
40, 60, 100, 150	0.14
250	0.55
400	0.80
600	0.84
1000	1.50
1500	2
2500	3

Other ratings and voltage drops are available on request.  
Dimensional drawings on page 187.

### SHUNTS FOR ADD-ON

Dimensions of shunts are adapted to meter connection contacts and can be easily fixed with M4 screws. The basic meter is provided with the measuring system 5 mA and measures voltage drop 60 mV. Only a corresponding scale has to be inserted. The shunts can be used on the housings 96 x 96 mm and 72 x 72 mm, and BN 0103 and BN 0203 meters. The accuracy class is 0.5.

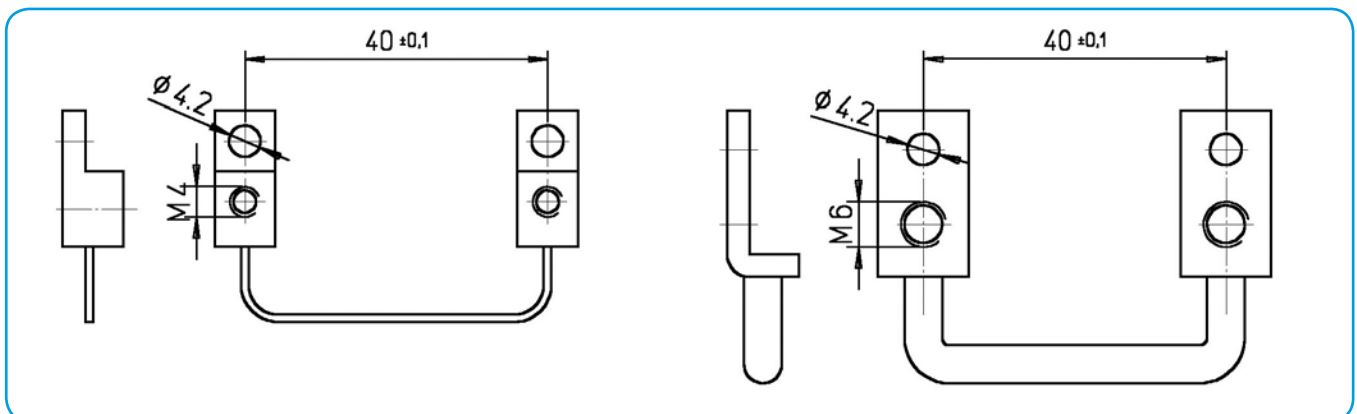

AR 0105

RATED CURRENT (A)/60 mV
1, 1.5, 2, 2.5, 4, 5, 6, 8, 10, 15, 20
25, 30, 40, 50, 60